

# Jeff Holder Builders Showcase Collection

THE RESERVE AT LAKE KEOWEE

PEACOCK GROVE  
DESIGN STUDIO  
864/859-8750



Mountain Ash  
FRONT ELEVATION

© 2009 PEACOCK GROVE DESIGN STUDIO

# Jeff Holder Builders Showcase Collection

THE RESERVE AT LAKE KEOWEE

## Mountain Ash

Main Level 1850 sf

Terrace Level 1480 sf  
LIVING AREA 1480 SF  
MECH/STORAGE 350 SF

**Total 3330 sf**

Garage 559 sf

Covered Entry 33 sf  
MAIN LEVEL

Covered Porch 140 sf  
MAIN LEVEL

Open Deck 144 sf  
MAIN LEVEL

Screened Porch 240 sf  
MAIN LEVEL

Terrace 384 sf  
LOWER LEVEL

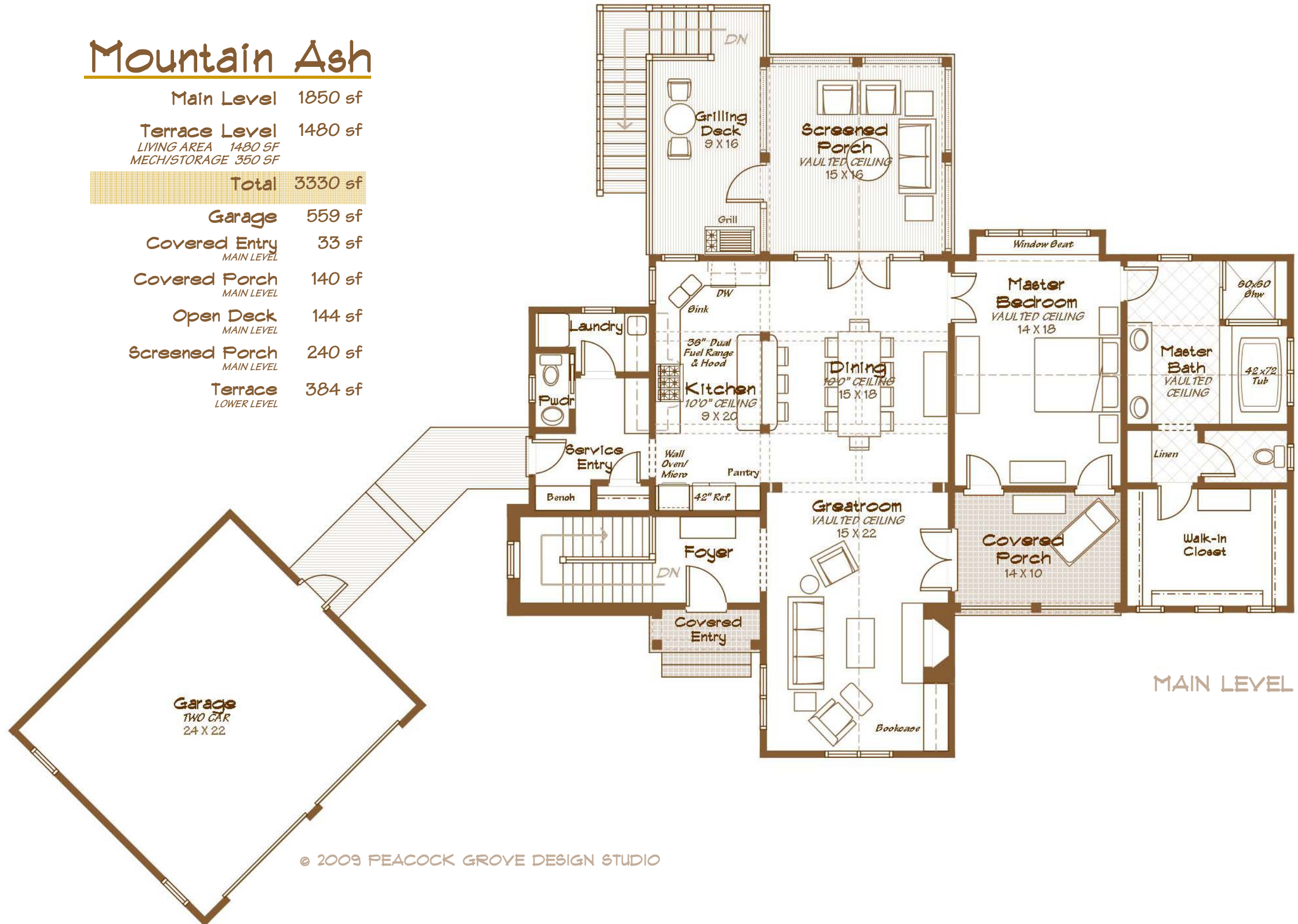

MAIN LEVEL

# Jeff Holder Builders Showcase Collection

THE RESERVE AT LAKE KEOWEE

## Mountain Ash

3 BEDROOM, 3 BATHS, 1 HALF BATH

This plan is designed for sloping lots and features an open greatroom, dining and kitchen area with access to both the covered and screened porches, taking advantage of views to both the front and rear. A stone fireplace with built-in bookcase is the focal point of the greatroom. The home features vaulted tongue and groove ceilings in the greatroom, master bedroom and screened porch. The kitchen and dining room are accented by a beamed ceiling and share a raised bar counter ideal for casual entertaining. The master suite is highlighted by a window seat and access to the covered porch and a bath with a vaulted tub area and a spacious walk-in closet. The terrace level features two guest bedrooms with two additional baths and a game room with wet bar and access to a terrace with enough room for a relaxing spa. A detached garage could be designed to accommodate a studio or guest suite above.

The rustic stone and board and batten exterior features timber accents with wavy edge siding in the gables. The cedar shake roof has standing seam roof accents.



# Jeff Holder Builders Showcase Collection

THE RESERVE AT LAKE KEOWEE

PEACOCK GROVE  
DESIGN STUDIO  
864/859-8750



REAR ELEVATION

## Exterior Materials: Mountain Ash

- Roof** - Treated cedar shake shingles
- Walls** - Natural stone veneer  
- Cedar board & batten siding
- Accents** - Cedar wavy edge siding  
- Heavy timber truss frames, posts & brackets  
- Standing seam roofing  
- Clad window & patio doors  
- Cedar Carriage House garage doors



**Roof:**  
Heavy Treated Hand-Split  
Cedar Shake Shingles



**Stone Veneer:**  
Natural Stone



**Wall Siding:**  
Cedar Board & Batten  
Siding



**Accent Siding:**  
Wavy-edge Cedar Siding